



VELA Hip Hop

VARIANT:

50/100

Manual no. 105493

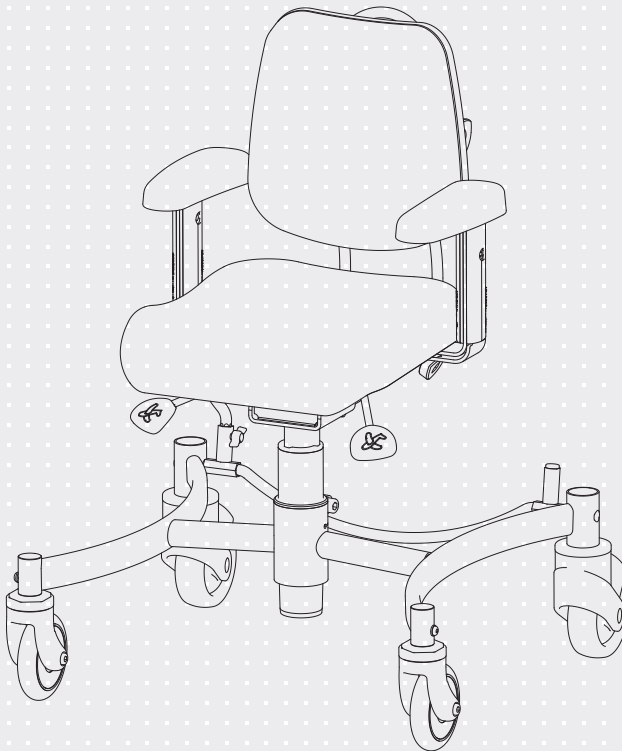

ISO 9001
ISO 14001

TABLE OF CONTENTS

1.0. INTRODUCTION	3
1.1. WARNINGS	4
1.2. TROUBLESHOOTING	5
1.3. LABELS USED ON THE CHAIR	6
1.4. SAFETY	7
1.4.1. Intended use	7
1.4.2. Transport	7
1.5. WARRANTY	7
1.6. UNPACKING THE CHAIR	8
1.7. MAINTENANCE	8
1.7.1. Wheels	8
1.7.2. Frame	8
1.7.3. Padding	8
1.7.4. Recycling guide	8
1.8. RECYCLING AND DISPOSAL	8
1.9. USER MANUAL	9
1.9.1. Adjustment of seat height	9
1.9.2. Adjustment of seat tilt	9
1.9.3. Adjustment of back height & angle	9
1.9.4. Brake	9
1.9.5. Adjustment of armrest, height	10
1.9.6. Adjustment of armrest, width & depth	10
1.9.7. Adjustment of seat depth	10
1.9.8. Adjustment of comfort wedges and zones	10

1.0. INTRODUCTION

DEAR CUSTOMER

Congratulations on your new VELA chair! We are sure this chair will give you daily pleasure. This user manual provides useful information on adjusting, operating and maintaining your chair.

Important

Please read this user manual carefully and keep it safe for when you need to refer to it. This manual is also available on VELA's website: www.vela.eu, where you can also find other relevant information.

If you have questions, experience errors or adverse events, please contact your VELA supplier.

We reserve the right to make changes.

VELA

Gøteborgvej 8-12
DK-9200 Aalborg
Denmark
www.vela.eu

1.1. WARNINGS



Use	In case of an allergic reaction, stop using the chair and consult a doctor
Use	Only use original spare parts from VELA
Use	Do not make any changes to the accessories that come with the chair
Use	Only use the chair for the intended purpose
Use	Only adjust the seat angle while the user's feet are on the floor
Use	Always have the chair brake on when you sit down or get up
Use	Never use the chair on surfaces with level differences as the chair may become unstable
Use	Maintenance other than cleaning should always be performed by a professional
Use	Never service the chair while it is in use
Use	Always follow the recommended maintenance and cleaning instructions
Use	The chair's functions are intended for the user. Only the user or trained professionals should adjust the chair while the user is sitting in it
Use	Risk of shearing or squeezing fingers in moving parts. Therefore, never use the chair if someone is touching underneath the seat
Choking hazard	Choking hazard on small parts. Never allow children to play with the chair, as small parts are removable



1.2. TROUBLESHOOTING

Mistake	Possible cause and solution
Manual height adjustment does not work	There is too much load or uneven load on the chair. Try to adjust the height without sitting in the chair. If this does not work, the gas cartridge is defective and should be replaced. Contact your VELA supplier
The brake function does not work	The brake is not activated. See section 1.9.4.
The armrest seems loose	One of the screws might be loose. Tighten the screw again
The chair rolls badly	Wheels are blocked. Clean the wheels for wire residue and the like

If the above does not solve your problem, you should contact your VELA supplier.

IN GENERAL

1.3. LABELS USED ON THE CHAIR

<p>Warning</p>	<p>Risk of shear and squeeze: Keep hands and fingers away from moving parts</p>	
<p>Labels</p>	<p>60 x 22.5 mm</p> <p>The last six digits are the product ID number:</p>	

Labels on the chair should be read at a distance of approx. 40 cm under normal daylight conditions.

For labels related to the operation of the chair, please refer to section 1.9.

1.4. SAFETY

This chair is CE marked and complies with applicable EU regulations.

The chair is manufactured by:
VELA, Gøteborgvej 8-12,
9200 Aalborg SV, Denmark.

1.4.1. INTENDED USE

This device is intended to support a child in a sitting posture while performing indoor activities of daily living, including school activities.

- :: The chair is not built to stand on
- :: The wheel brake must always be activated when sitting down or standing up

All variants of this chair are tested and approved for a maximum load of 60 kg. For optimal use, the chair's recommended user weight is 15-50 kg.

Note: Persons using a harness in the chair must always be supervised when the harness is in use.

1.4.2. TRANSPORT

When transporting the chair by car, airplane or any other means of transport, always use the chair brake. The chair is not approved for use as a passenger seat in any means of transportation and may not be used as such.

The chair is designed to be transported under the following environmental conditions:

Temperature: - 20°C to + 60°C

Humidity: 15-95%

Allow the chair to stand for 24 hours before use if it has been stored below - 10°C.

1.5. WARRANTY

VELA grants a right of claim under applicable law in the country where the chair is acquired. The right of complaint applies only when using original spare parts and accessories, as well as customisations made by professionals.

Note: if an exclusive contractual agreement has been made directly with VELA, this applies!

VELA assumes no liability for damages to the product or the user caused by:

- :: Transportation
- :: Misuse
- :: Normal wear and tear
- :: Wrong use
- :: Use of spare parts and accessories that are not original VELA products
- :: Adjustments made by unauthorised service technicians

1.6. UNPACKING THE CHAIR

The chair comes in environmentally friendly and recyclable packaging.

In case of defects or transport damage to the chair, please contact your VELA supplier right away. In such cases, do not attempt to use the chair or to fix it yourself.

On delivery you have received:

:: VELA chair

:: Instructions for use

1.7. MAINTENANCE

We recommend an annual inspection of the chair to identify any defective or worn parts. All removable parts should be tightened regularly. You can find various guides on www.vela.eu.

1.7.1. WHEELS

We recommended you regularly check the wheels and remove any residual threads, etc.

1.7.2. FRAME

Clean with lukewarm water and if necessary, add some pH-neutral detergent.

1.7.3. PADDING

Fabric: Clean by chemical cleaning, with furniture cleaner or with water using a hard-wrung cloth.

Synthetic fabric or leather: Clean with water or mild soap using a hard-wrung cloth.

Leather: Clean by vacuuming with a soft brush. Avoid using detergent.

Note: On www.vela.eu you can find cleaning instructions for all our standard upholstery types.

1.7.4. RECYCLING GUIDE

Your VELA chair can be reused by another person when you no longer need it as long as the chair is serviced by a technician beforehand.

The life expectancy of the chair is five years for regular and proper use as long as VELA, your VELA supplier or a trained professional perform an annual inspection with replacement of worn parts.

1.8. RECYCLING AND DISPOSAL

This product contains recyclable materials. Therefore, the product must be disposed of in accordance with local regulations and not together with ordinary household waste. Proper disposal and recycling will help prevent negative effects on the environment and people.

1.9. USER MANUAL

Replacement of the gas spring may only be performed by the service support team from your dealer or a skilled technical person.

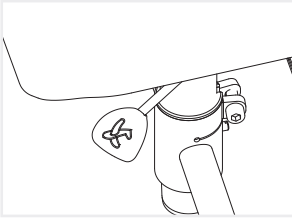

1.9.1. ADJUSTMENT OF SEAT HEIGHT

Adjust the seat height by pushing the lever placed below the seat.

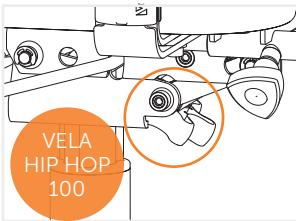

1.9.2. ADJUSTMENT OF SEAT TILT

Adjust the seat tilt by turning the handle below the seat.

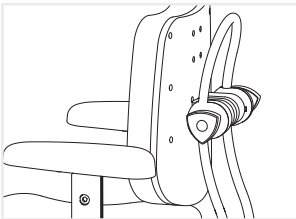

1.9.3. ADJUSTMENT OF BACK HEIGHT & ANGLE

Adjust the back height and angle by turning both knobs on the back of the backrest. Remember to tighten the knobs again afterwards.

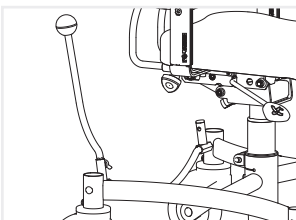

1.9.4. BRAKE

The chair brakes by moving the lever on the side of the chair forward. Unlock the chair by moving the handle back into upright position.

Note: The brake can be moved by loosening the screw at the bottom of the brake lever, remove the plastic knob on the opposite side hole and insert the brake lever. Remember to tighten the lever again.

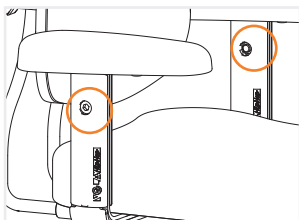

1.9.5. ADJUSTMENT OF ARMREST, HEIGHT

Adjust by loosening the screw (Allen key) on the armrest bar and regulate the height of the armrest. Remember to tighten the screw afterwards.

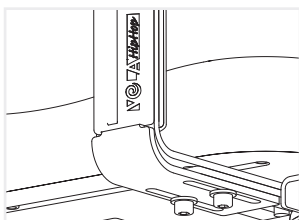

1.9.6. ADJUSTMENT OF ARMREST, WIDTH & DEPTH

Adjust by loosening the screw (Allen key) underneath the seat and regulate the width/depth of the armrest. Remember to tighten the screw afterwards.

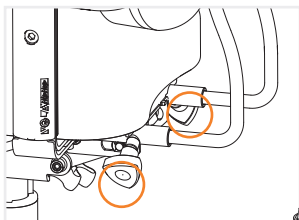

1.9.7. ADJUSTMENT OF SEAT DEPTH

Adjust by loosening the hand screws underneath the seat and regulate the depth by pushing/pulling the backrest. Remember to tighten the screw afterwards.



1.9.8. ADJUSTMENT OF COMFORT WEDGES AND ZONES

It is possible to adjust the comfort of the seat via the zipper placed on the back of the seat cushion. This makes it possible to insert/remove or change the wedges and comfort zones of the seat.

